

# BF10

BARRE FILETTATE  
THREADED BARS



# BF20

BARRE FILETTATE INOX  
STAINLESS STEEL THREADED BARS



Su richiesta anche sinistre  
On request also left-hand threaded

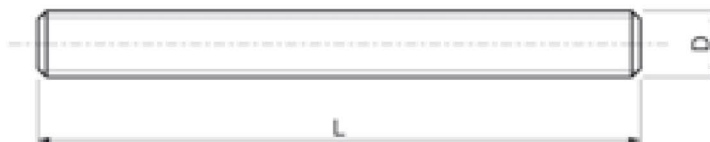

Materiale: 42CrMoS4 Classe 10.9  
Filetto ottenuto per rullatura.

Material: 42CrMoS4 Class 10.9  
Rolled thread.

Code	D	L	
BF10.00006	M6	1000	0,200
BF10.00008	M8	1000	0,350
BF10.00010	M10	1000	0,550
BF10.00012	M12	1000	0,800
BF10.00014	M14	1000	1,000
BF10.00016	M16	1000	1,300
BF10.00018	M18	1000	1,600
BF10.00020	M20	1000	2,100
BF10.00022	M22	1000	2,600
BF10.00024	M24	1000	3,000
BF10.00027	M27	1000	3,900
BF10.00030	M30	1000	5,000
BF10.00033	M33	1000	6,000
BF10.00036	M36	1000	6,900
BF10.00042	M42	1000	9,300
BF10.00048	M48	1000	12,200

Si eseguono su richiesta misure non a catalogo / Other sizes can be supplied on request.

Materiale: acciaio inox AISI 304 Classe A2  
Filetto ottenuto per rullatura.

Material: stainless steel AISI 304 Class A2.  
Rolled thread.

Code	D	L	
BF20.00006	M6	1000	0,200
BF20.00008	M8	1000	0,350
BF20.00010	M10	1000	0,550
BF20.00012	M12	1000	0,800
BF20.00014	M14	1000	1,000
BF20.00016	M16	1000	1,300
BF20.00018	M18	1000	1,600
BF20.00020	M20	1000	2,100
BF20.00022	M22	1000	2,600
BF20.00024	M24	1000	3,000
BF20.00027	M27	1000	3,900
BF20.00030	M30	1000	5,000
BF20.00036	M36	1000	6,900

Si eseguono su richiesta misure non a catalogo / Other sizes can be supplied on request.

Su richiesta è disponibile la fornitura dell'attestato di controllo 2.2 e del certificato 3.1.B. / On demand it is available the supply of certificates 2.2 and 3.1.B.